

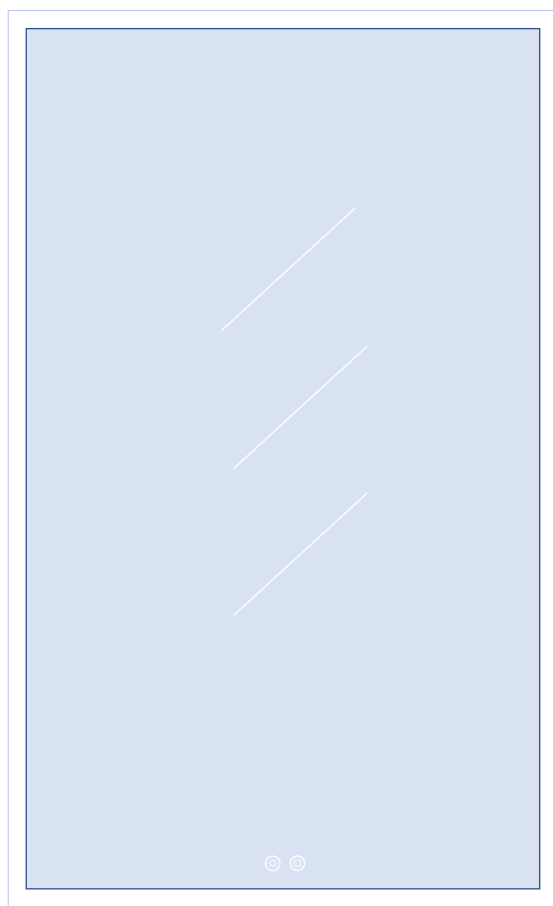

LED Mirror

INSTALLATION AND OPERATING INSTRUCTION



Questions?

Please call or email us – our friendly associates are ready to help.

Tel: 0086 516 83567656

Email: service@byecold.com

READ BEFORE USE

- Thank you for purchasing this Byecold LED mirror.
- Please read the instructions carefully before attempting to install, operate or service the product.
- Please retain this booklet for future reference.
- Pictures for reference only, subject to our available products

SCOPE OF DELIVERY

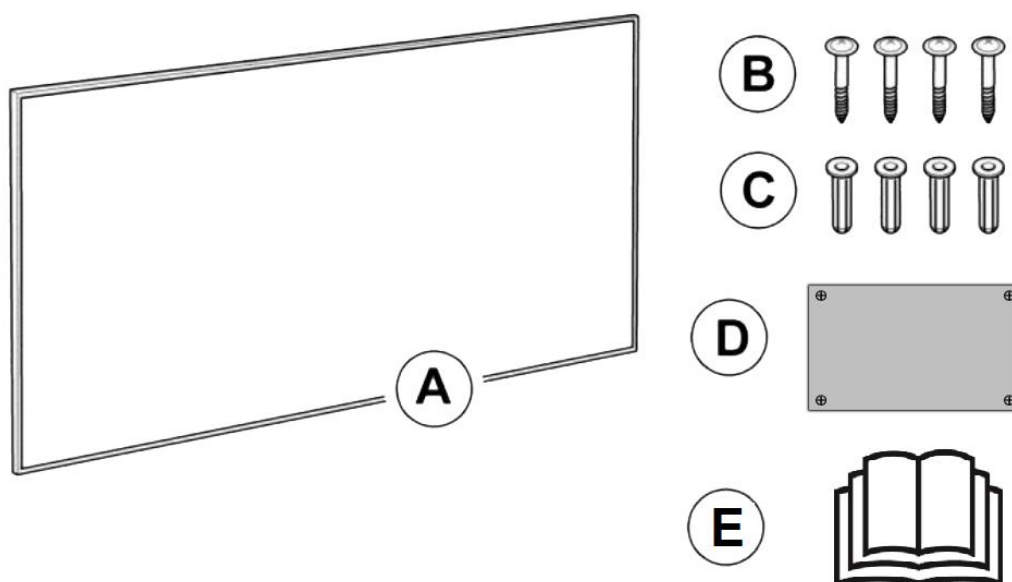

A: LED Mirror × 1

B: Screw × 4

C: Dowel × 4

D: Drill template × 1

E: Manual × 1

CONTENTS

Product Introduction.....	1
Safety Introduction.....	1
Product Information.....	4
Installation.....	5
Operation.....	6
Maintenance.....	7
Troubleshooting.....	7
Warranty.....	8

PRODUCT INTRODUCTION

Byecold LED mirror is a stylish & modern luxury Led illuminated bathroom mirror with defogging function. It does not only serve as a decoration of your bathroom, but also provides perfect glance of your beauty.

SAFETY INTRODUCTION

Read this manual carefully before starting or using the device. Always store the manual in the immediate vicinity of the device or its site of use!



Warning

Do not ceiling mount those devices designed for wall only!
Or else it may cause burning, fire and falling off risk!



Warning

This appliance can be used by children aged from 8 years and above and persons with reduced physical, sensory or mental capabilities or lack of experience and knowledge if they have been given supervision or instruction concerning use of the appliance in a safe way and understand the hazards involved.

Children shall not play with the appliance. Cleaning and user maintenance shall not be made by children without supervision.



Warning

Children of less than 3 years should be kept away unless continuously supervised.

Children aged from 3 years and less than 8 years shall only switch on/off the appliance provided that it has been placed or installed in its intended normal operating position and they have been given supervision or instruction concerning use of the appliance in a safe way and understand the hazards involved.

Children aged from 3 years and less than 8 years shall not plug in, regulate and clean the appliance or perform user maintenance.



Warning

Do not use the device in small rooms if persons are present who cannot leave the room independently and who are not under constant supervision.



Warning

Some parts of this product can become very hot and cause burns. Particular attention has to be given where children and vulnerable people are present. Its dangerous of installation close to curtains and other combustible materials. To avoid the possibility of burns, the following people should be much more careful when using the heaters: infants and kids,

people with sensitive skin, the old, the sick, people who is drunk, people who takes sleeping pills.

- Remove all the blue protective films(both on the front and on the back) before using.
- Be sure the usage voltage is between 110-240V, 50Hz, and power supply has been strictly in accordance with IEC, left is null wire and right is live wire, and also well grounded.
- The devices will draw more current than small appliances, so a separate 5A socket is required.
- Do not use the device in potentially explosive rooms.
- Do not use the device in aggressive atmosphere.
- Set the device up in an upright and stable position.
- Let the device dry out after a wet clean. Do not operate it when wet.
- Do not use the device with wet or damp hands.
- Do not expose the device to directly squirting water.
- Never insert any objects or limbs into the device.
- Do not cover or transport the device during operation.
- Do not sit on the device.
- This appliance is not a toy! Keep away from children and animals. Do not leave the device unattended during operation.
- Check accessories and connection parts for possible damage prior to every use of the device. Do not use any defective devices or device parts.
- Ensure that all electric cables outside of the device are protected from damage (e.g. caused by animals). Never use the device if electric cables or the power connection are damaged!
- The electrical connection must be according to the specifications in chapter Technical data.
- Insert the mains plug into a properly secured mains socket.
- Do not use the device when the socket or wire overloaded.
- Observe the device's power input, cable length and intended use when selecting extensions to the power cable. Completely unroll extension cables. Avoid electrical overload.
- Before carrying out maintenance, care or repair work on the device, remove the mains plug from the mains socket. Hold onto the mains plug while doing so.
- Switch the device off and disconnect the power cable from the mains socket when the device is not in use.

- Do not under any circumstances use the device if you detect damages on the mains plug or power cable. If the supply cord is damaged, it must be replaced by the manufacturer, its service agent or similarly qualified persons in order to avoid a hazard. Defective power cables pose a serious health risk.
- During the installation of the device observe the minimum distances from walls and other objects as well as the storage and operating conditions specified in the Technical data chapter.
- Never drill into the heating device.
- Do not use the device once any damage found on the glass or mirror surface.
- Do not use the device in immediate proximity to curtains.
- Do not place the device on combustible ground.
- Do not transport the device during operation.
- Allow the device to cool down before transport and / or maintenance work.
- Do not use this device near bathtubs, shower trays, swimming pools or other water containers. Risk of electric shock!
- The device must be placed where the switches and controllers cannot be touched by a person in a bathtub or shower.
- Do not use this device in a child-care centre.
- Do not place any objects, e.g. clothing, on the device.
- Do not use the device outdoors. Do not place the device on wet or flooded ground.
- Do not unplug by pulling on the cable. To unplug, grasp the plug, not the cable.
- Do not stretch the cable or place the cable under strain.



Keep cable away from heated surfaces.

- Do not run the cable under carpeting. Do not cover the cable with throw rugs, runners, or similar coverings. Do not route the cable under furniture or appliances. To avoid a tripping hazard arrange the cable away from traffic areas so that it will not be tripped over.
- Do not use on soft surfaces, such as a bed, where openings may become blocked.
- Keep combustible materials, such as furniture, pillows, bedding, papers, clothes and curtains, at least 0.9m (3 feet) from the front of the appliance and keep them away from the sides and rear when the appliance is plugged in.
- If there is a loose fit between the plug and the socket or the plug becomes very hot, the socket may

need to be replaced. Check with a qualified electrician to replace the socket.

- Turn off all controls before unplugging. Unplug before connecting any tool or accessory.
- Do not privately disassemble the device or replace parts, otherwise it may cause mechanical failure, electric shock, fire or body injury.
- The warranty is not applicable for the product fault caused by private disassembly.



Warning:

Do not cover.

Insert the mains plug into an outlet that is properly installed and grounded.

Do not locate directly below a mains electricity supply socket.

PRODUCT INFORMATION

TECHNICAL DATA

Model	BKD-G0806-LH/D	BKD-G1006-LH/D	BKD-G1206-LH/D
Size	23.6×31.5 inch	23.6×39.4 inch	23.6×47.2 inch
Thickness (after installation)	1.8 inch	1.8 inch	1.8 inch
Net Weight	9.8KG	12.2KG	14.9KG
Rated Voltage	110-240V/50HZ		
Heating/Defogging Power	250W/35W	350W/50W	500W/66W
LED Light	3000K-6000K Brightness Adjustment		
Material	Tempered Mirror + Aluminum		
Switch	Smart Touch Sensor Switch		
Installation	Support both vertically and horizontally mounting		

Note: Heating and Defogging functions should be mutually exclusive.

STRUCTURE

(Front)

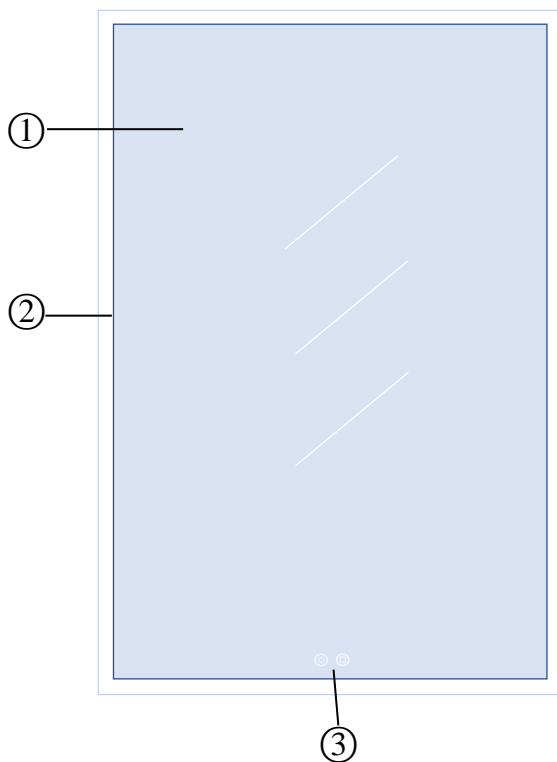

(Back)

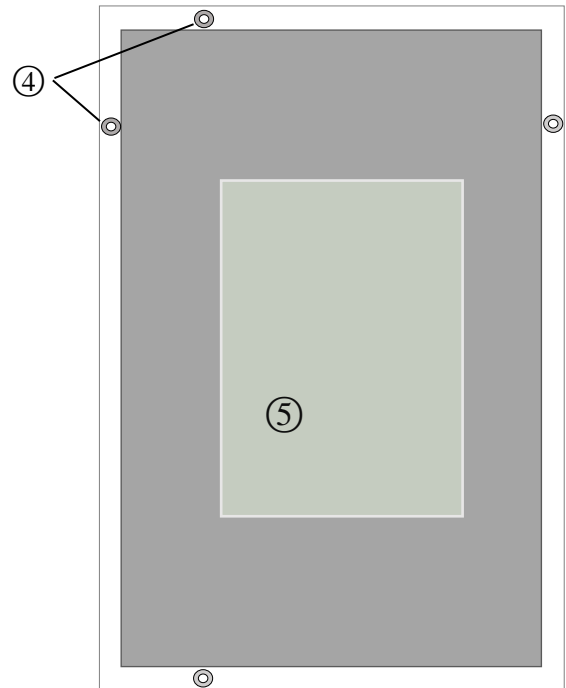

- ① Mirror Surface
- ② LED Strip Light
- ③ Touch Switches
- ④ Mounting Holes
- ⑤ Anti-fogging Film

INSTALLATION

- (1) Choose the mounting position, keep the required minimum distances (Please select correct mounting holes in order to install the mirror vertically or horizontally);
- (2) Mark the positions for the bore holes onto the drilling template (D) if there are no existing marks. Stick the drilling template on the wall;

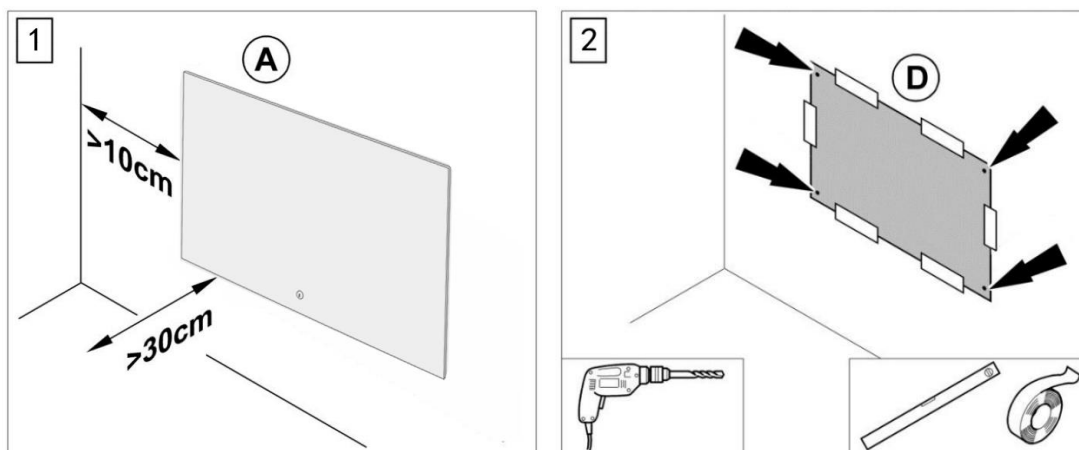

(3) Drill the holes. Insert the screws into the dowels and fasten the screws. The screws should protrude approx.1.5 cm from the dowels;

(4) Tear off the back protective film, Hang the mirror (A) on the screws and move it to one direction.

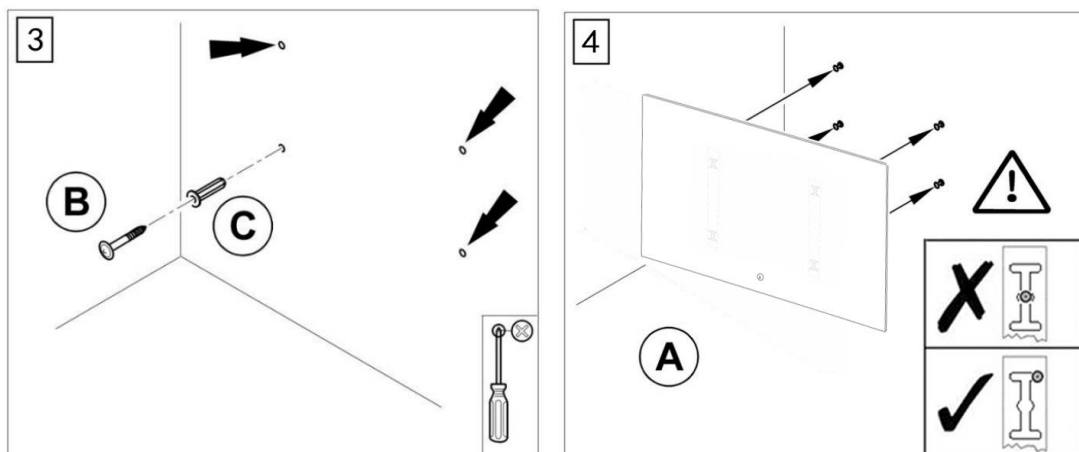

Note: please tear off the front and back protective film once you start using the device.



OPERATION

START-UP:

1. Check if the power cord is intact.
2. Check if the power supply voltage is consistent.(***The power socket is required to have a grounding terminal and good grounding performance.***)
3. Whether the power cord plug and socket are matched, the socket can withstand 110-240V/50HZ, 10A. If it is lower than this value, it cannot be used to avoid accidents.

FUNCTIONAL OPERATING INSTRUCTIONS:

Plug in power, the backlit of the touch button is in the active (lighted white) status.

Button	Actions	Output
	Single Click	Turn on/off the LED light
	Double Click	Switch the LED color between warm white and cold white
	Long Press	Brightness + or -
	Single Click	Turn on/off the LED light of magnifier(If available)
	Double Click	Turn on/off the screen display(If available)
	Long Press	Turn on/off heating or defogging

MAINTENANCE

- ☑ The appliance must be switched off and unplugged before taking regular cleaning.
Otherwise, it may cause electric shock..
- ☑ The appliance needed only external cleaning and care regularly.
- ☑ Please use some medicinal alcohol clean the surface with damped soft cloth. Never clean it under running water. Do not use thinner, toluene, benzene, acidic/alcoholic cleaning agents, or any chemical clothes on the appliance.
- ☑ After regular care and cleaning, well pack it into the original packing box, then put it to dry and cool environment for storage.
- ☑ Wind and keep dry the cable when not in use.

TROUBLESHOOTING

The device has been checked for proper functioning several times during production. If malfunction occur nonetheless, check the device according to the following list.

Problem	Reason	Measure
The touch button does not light	The device does not start	1) Check the power connection 2) Use fingerprints instead of fingertips
The surface bulges slightly	The material expands due to heating	It's a normal process. No measure are required.
The mirror surface is hot all the while	The defogging function has been in operation for long time	Make sure to turn off the defogging function when not needed.

Warranty Card

NAME _____ TEL _____

ADD _____

MODEL _____ ORDER NO. _____

Date _____

Failure Description

THANK YOU FOR CHOOSING TO BUY A BYECOLD APPLIANCE.

Customers can contact us for repairing or replacement of your Byecold appliance if it is found to be defective due to faulty materials, workmanship or function within 1 years of purchase or delivery.

Byecold does not guarantee the repair or replacement of a product where a defect is the result of:

- Damage caused by not carrying out the recommended appliance maintenance.
- Accidental damage, faults caused by negligent use or care, misuse, neglect, careless operation or handling of the appliance which is not in accordance with our Operating Manual.
- Use of the appliance for anything other than normal domestic household purposes.
- Faulty installation .
- Repairs or alterations carried out by parties other than Byecold or its authorised agents.

If you are in any doubt as to what is covered by your guarantee, please contact us.



JIANGSU BYECOLD TECHNOLOGY CO.LTD

 No.666,Mingzhu Industry Zone, Zhaodun Town, Pizhou City, Jiangsu

 www.byecold.com

 TEL: +86 516 83567656